

# Universal wide tolerance flange adaptor Series C1 40

**Enables the mechanical jointing of a flange and a pipe, of different materials and outside diameters.**



## Description

- Wide tolerance range: an average of 21 mm.
- Small number of models for a Nominal Diameter.
- High performance:
  - Permanent leak tight joint when compressing the gasket between the end ring and the sleeve onto the pipe.
  - Anticorrosion protection: epoxy powder coating (200 µm) and Geomet 500® Gr. B for the bolts.
- Ease and speed of installation:
  - Angular deflection  $\pm 6^\circ$ .
  - Accommodates misalignment.
  - Absorbs expansion and contraction.
  - Important setting gap.
- Conformity to standards:
  - NF A 48-830: Foundry products - Spheroidal graphite cast iron fittings for PVC drinking water pipes under pressure.
  - EN 545: Ductile iron pipes, fittings, accessories and their joints for water pipelines - requirements and test methods.
  - EN 1092-2: Flanges and their joints. Part 2: Cast iron flanges.
  - ISO 2531: Ductile iron pipes, fittings, and accessories and their joints for water applications.
  - ISO 7005-2: Metallic flanges and cast iron flanges.
  - ISO 7483: Dimensions of gaskets for use with flanges to ISO 7005.
- Approval:
  - Drinking water approved.
- Nota:
  - This coupling does not resist to longitudinal forces and pipe pull out will occur. Ensure adequate restraint is provided.
  - Not recommended for PE pipes.

## Technical data

- Range: DN 300 to 500.
- Maximal working pressure: PN 16.
- Flanges drilling ISO PN 10/16 excepted ref. 2214-A drilled ISO PN 16 only.
- Temperatures: from  $+0^\circ$  to  $+60^\circ\text{C}$ .
- Torque: 60 to 70 Nm.

## Applications

- Drinking water networks.
- Pumping, treatment, watertank.
- Fire protection networks.
- Irrigation networks.
- Sewage networks and rain waters drainage (WC type - NF EN 681-1).

## Tests

- Sealing test according to standard ISO 2531.

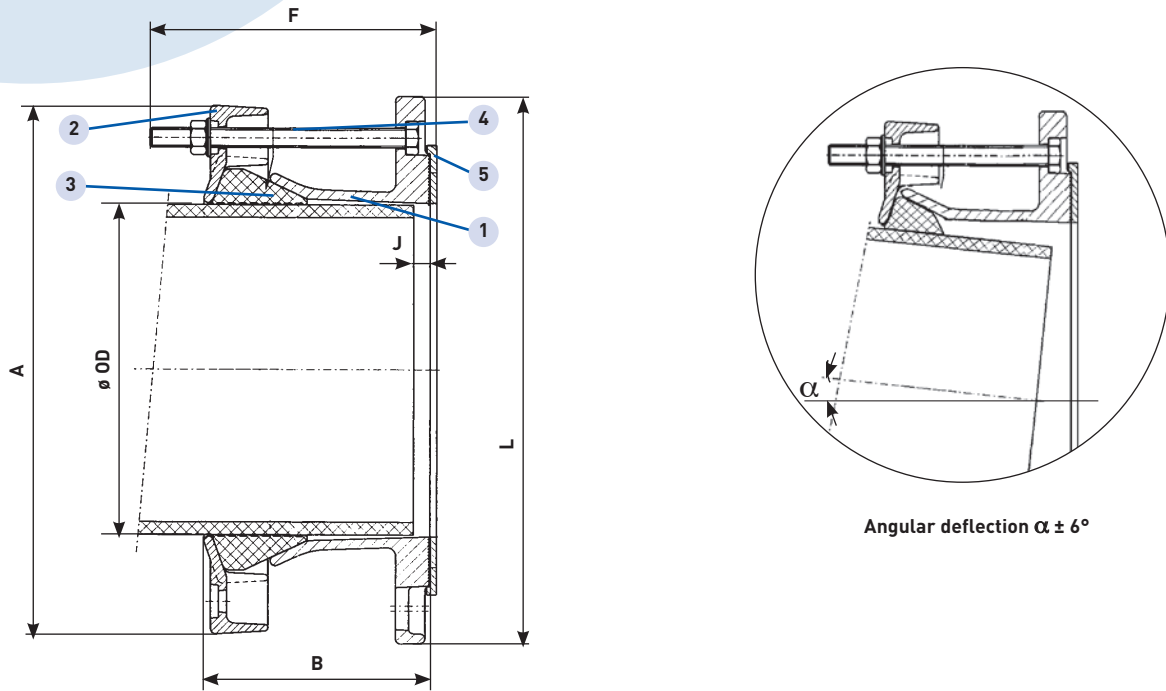

Item	Designation	Qty	Materials	Standards
1	Flange	1	Ductile iron /EN-GJS-500-7	EN 1563
2	End-ring	1	Ductile iron /EN-GJS-500-7	EN 1563
3	Gasket	1	EPDM	EN 681-1
4	Bolts	acc/DN	Steel 8.8* Geomet® coating	EN 10083-2
5	Flange gasket for ref. 2211 to 2217	1	EPDM	EN 681-1

\* Stainless steel on request

## BGT Range

DN	Drilling	Ref	OD mini mm	OD maxi mm	L mm	A mm	F mm	B mm	J mini mm	J maxi mm	Bolts	Weight kg
300	300	2213-C	360	386	498	510	260	243	83	155	6-M12x250	36.4
350	350	2214	360	386	533	510	170	160	10	70	8-M12x160	25.0
350	350 ISO PN 16	2214-A	386	410	540	540	190	170	10	80	8-M12x180	28.1
400	400	2215	408	435	596	560	170	160	10	70	8-M12x160	28.3
400 A	400	2216	425	458	596	585	190	165	10	80	8-M12x180	29.8
400 B	400	2217	465	500	630	630	300	238	83	155	8-M12x290	44.3

**A:** The gasket already mounted on the product concerns the tolerance range of 425/448.  
A second gasket is delivered and must be mounted instead of previous gasket to obtain tolerance range of 438/458.

**B:** The gasket already mounted on the product concerns the tolerance range of 465/490.  
A second gasket is delivered and must be mounted instead of previous gasket to obtain tolerance range of 480/500.